

Marwi item: CB-085
Standard bearing number: 6902 2RS
Dimension (mm): 15 x 28 x 7

Scale 1:1

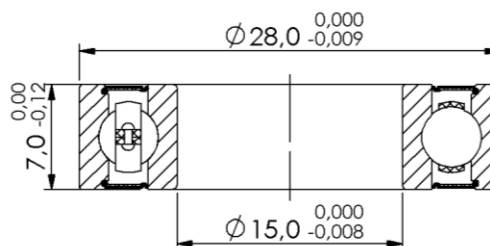

Scale 2:1



Technical specifications:

Races:	CrMo
Balls:	CrMo (HRC 61-66)
Retainer:	Steel
Sealing:	Rubber 2RS (light contact)
Grease:	Multemp SRL (Kyodo Yushi)
Tolerance:	ABEC-3
Quantity of balls:	10 pcs
Dimension of balls:	3,969mm (5/32")
Basic dynamic load rating:	4,650 kN
Basic static load rating:	2,260 kN

Applications:

Hub / wheel:	Specialized, Bontrager, FSA, Easton, Hope, Goldtec, Stan's, Zipp and many other brands
Frame (suspension pivot):	Various brands