

Marwi item: CB-105
Standard bearing number: MR17287 2RS
Dimension (mm): 17 x 28 x 7

Scale 1:1

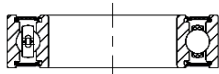

Scale 2:1

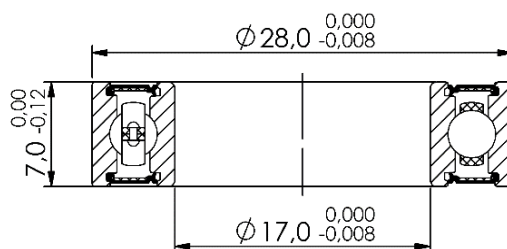

Technical specifications:

Races:	CrMo
Balls:	CrMo (HRC 61-66)
Retainer:	Steel
Sealing:	Rubber LLB (non contact)
Grease:	Multemp SRL (Kyodo Yushi)
Tolerance:	ABEC-3
Quantity of balls:	12 pcs
Dimension of balls:	3,175mm (1/8")
Basic dynamic load rating:	1,813 kN
Basic static load rating:	1,137 kN

Applications:

Hub / wheel:	Hope Pro II Evo Freehub and Pro III Front and many other brands
Frame (suspension pivot):	Salsa and some other brands