

Marwi item: CB-260
Standard bearing number: 6809 2RS
Dimension (mm): 45 x 58 x 7

Scale 1:1

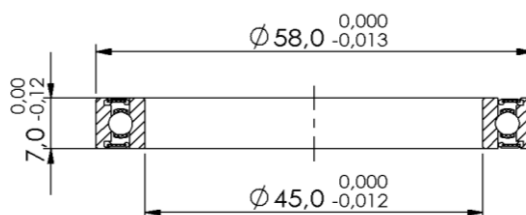

Technical specifications:

Races:	CrMo
Balls:	CrMo (HRC 61-66)
Retainer:	Steel
Sealing:	Rubber 2RS (light contact)
Grease:	Multemp SRL (Kyodo Yushi)
Tolerance:	ABEC-3
Quantity of balls:	27 pcs
Dimension of balls:	3,175mm (1/8")
Basic dynamic load rating:	5,350 kN
Basic static load rating:	4,950 kN

Applications:

Hub / wheel:	Industry9 and some other brands
Bottom bracket:	Various brands
Frame (suspension pivot):	Various brands