

Marwi item: CB-780
Dimension (mm): 40,0 x 51,9 x 8,0
Angle: 45° / 45°

Scale 1:1

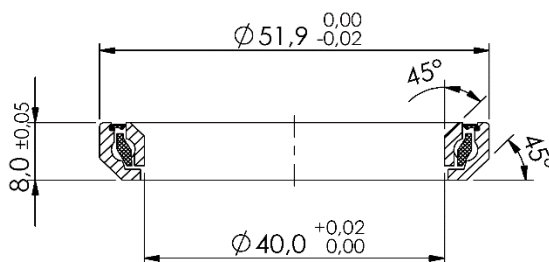

Technical specifications:

Races:	CrMo
Balls:	CrMo (HRC 61-66)
Retainer:	Nylon
Sealing:	Rubber LLU (full contact)
Grease:	Multemp SRL (Kyodo Yushi)
Tolerance:	ABEC-3
Quantity of balls:	30 pcs
Dimension of balls:	3,175mm (1/8")
Basic dynamic load rating:	4,820 kN
Basic static load rating:	4,1550 kN

Applications:

Headset: Scott Foil, Ritchey and various other brands